

NMI Saferider 2 Millock with Upper Belt Mount (Code SAF MUS): User Instruction Leaflet

To be operated by trained personnel only

Setting up and applying the webbing to secure the wheelchair

1: Attaching Fixed Straps to the front of the wheelchair

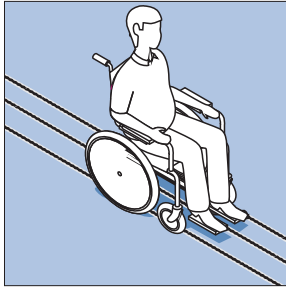

Position the wheelchair where the tracking is set at the measured centres

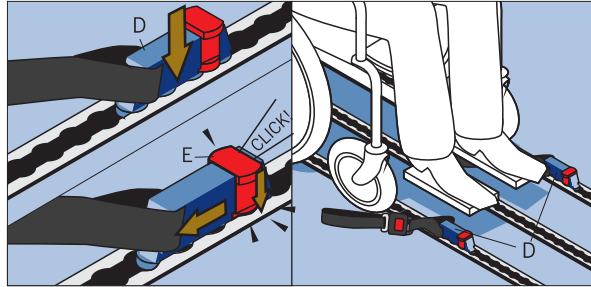

To attach the front fixed belts push D into the tracking in the required position. Slide the Plunger Stud Fitting until plunger E drops into a hole in the floor tracking

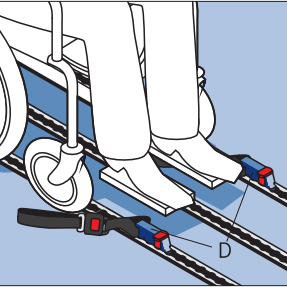

The devices (D) are now locked in the floor tracking

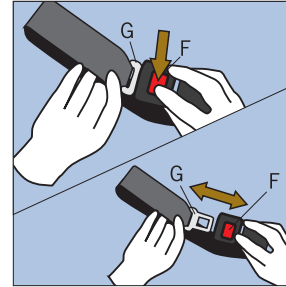

Separate belt tongue G and buckle by pressing button F while pulling apart

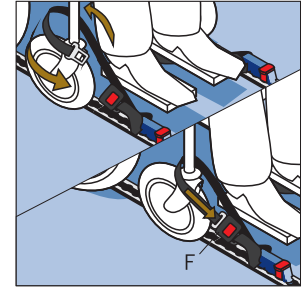

Wrap around appropriate attachment point on front of wheelchair and reconnect with buckle F. Repeat process on other side of wheelchair

2: Securing the Safe Rider & attaching Adjustable Straps to the rear of the wheelchair securing it from movement

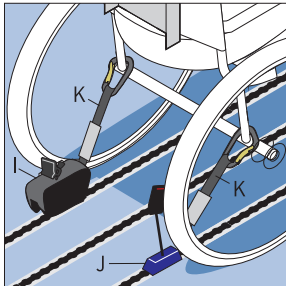

Position the floor mounted lap and diagonal inertia reel belts I and stalk fixture J in the tracking and attach rear adjustable belts K to the rear of the wheelchair. Refer to NMI Standard Lap and Diagonal Belt Combined Restraints instruction sheet

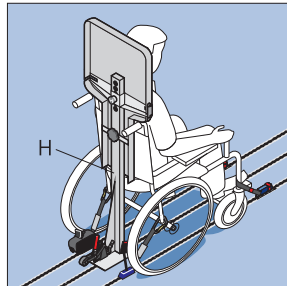

Position the Saferider millock H in the centrally positioned track behind the wheelchair and insert it into the tracking. See Note 1 below to insert the Saferider into the tracking

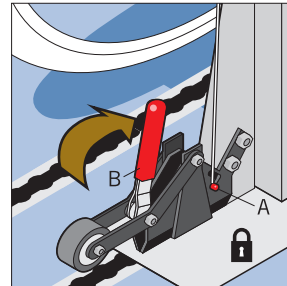

Close handle B to lock the Saferider in its new position. Safety bolt A should rest in their lower position.

Continued on next page...

Notes

Note 1: Unlocking the Millennium Fitting

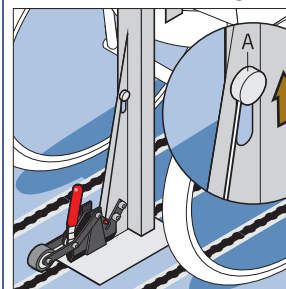

To unlock the Millennium Fitting either to prepare it to insert it into the tracking or to remove the Saferider lift bolt A

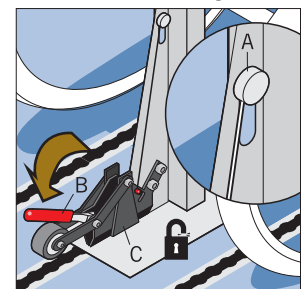

While holding safety bolt A in its upper position pull clamp B away from the Millennium 2 fitting C to unlock. The restraint device is now unlocked and can be inserted into the floor tracking

...Continued:

3: Adjusting the height of the saferider

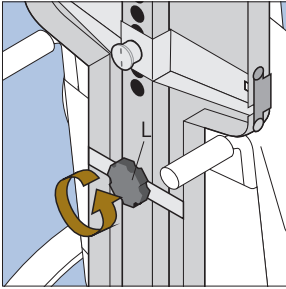

To adjust the height of the back/headrest of the Saferider first turn Star handle L anti-clockwise to unlock

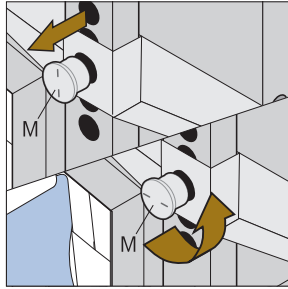

Pull out plunger M and turn it 90°

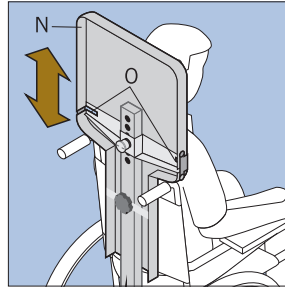

Slide the back/headrest N up or down the post so the upper belt mount (O) sits level with the wheelchair occupant's shoulder

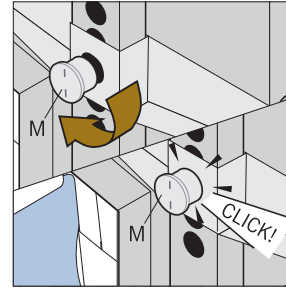

Once in position turn Plunger M so the lines point up and down. Plunger M should drop into one of the holes. If it doesn't you may have to slide the backrest up or down till it drops into the nearest hole

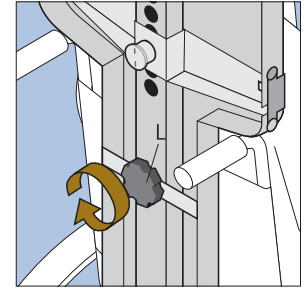

Finally lock the back/headrest in position by turning Star handle L clockwise

Note: Do not over tighten

4: Applying the occupant belts

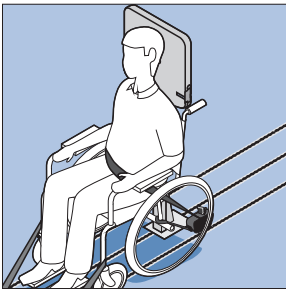

First place the black coloured lap belt across the occupant and into the stalk fixture

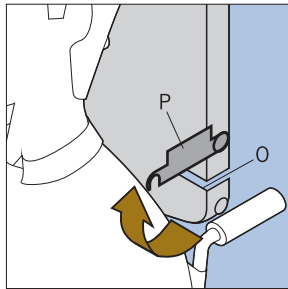

Rotate safety catch P to gain access to upper belt mount O

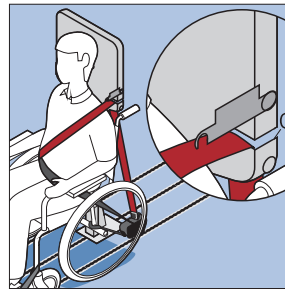

Feed the burgundy coloured diagonal belt through the upper belt mount O, round the occupant and into the floor mounted stalk fixture

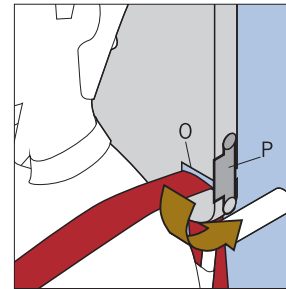

Rotate safety catch P to close upper belt mount O

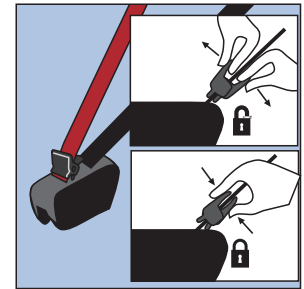

Note: Where the upper belt mount sits slightly too high above the shoulder (due to wheelchair handlebars) use the comfort clip located on the burgundy diagonal belt. Simply pull out the webbing to allow some slack then click the comfort clip together.

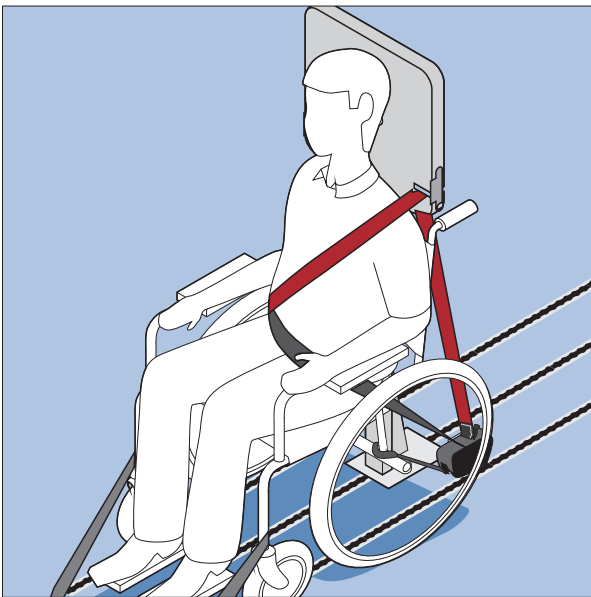

The wheelchair and wheelchair occupant are now safely secured and ready to travel in the vehicle