

Fig.1 Shows the seats in normal configuration (ie no wheelchair passengers)

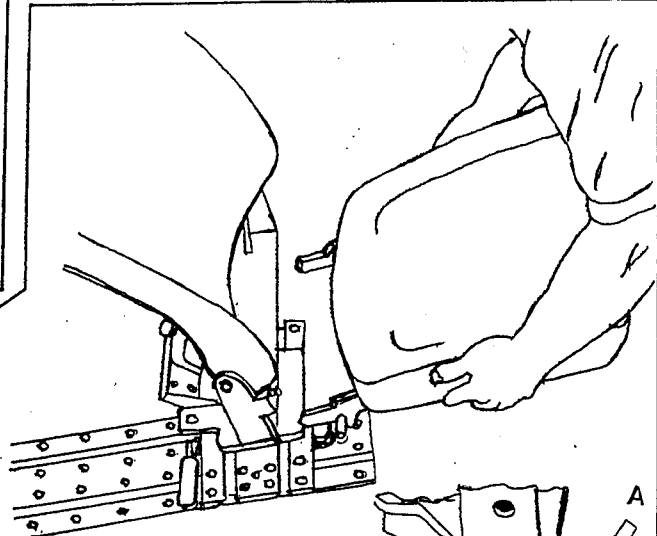
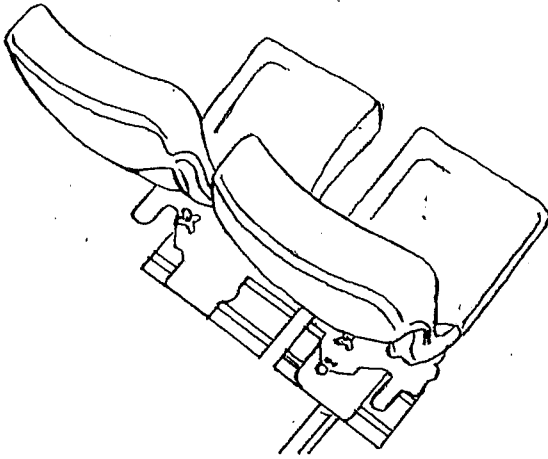

Fig.2

To ready the seats to accommodate a wheelchair passenger first remove the seat cushions.

To remove the seat cushions release the restraining hooks located on the outside of the seat frame by pulling out the plunger 'A' and rotate the hook upward. This should be done on both sides of the seat. Now lift the front of the cushion slightly and slide the cushion forward. This applies to both seats.

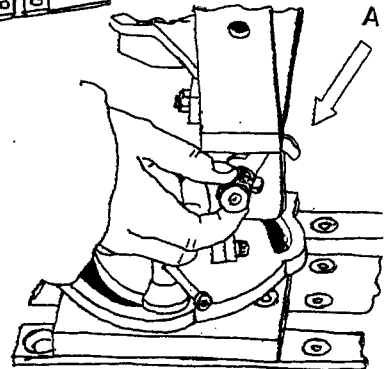

Fig.3

The next step is to move the seat nearest the aisle to its rearmost position in the track plate.

To do this unscrew the black finger knob located on the seat frame behind the seat back anti-clockwise until the seat is loose.

The second operation is to release the foot lock 'A' located at the rear of the seat frame just above the track plate 'B'. To operate the footlock depress pedal 'C' and at the same time rotate lock 'D' anti-clockwise. Once the lock is moved clear of the foot pedal, the foot pedal can be released.

Now slide the seat back in the track plate until it engages the stop at the end of the track plate.

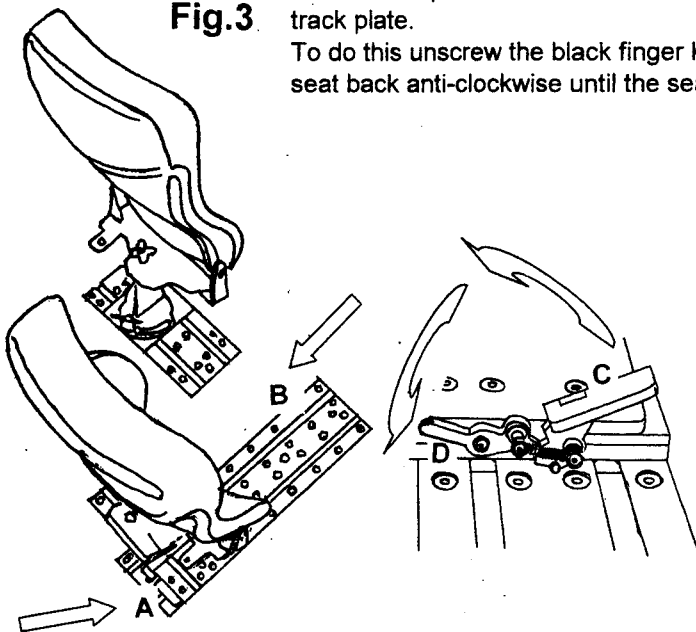

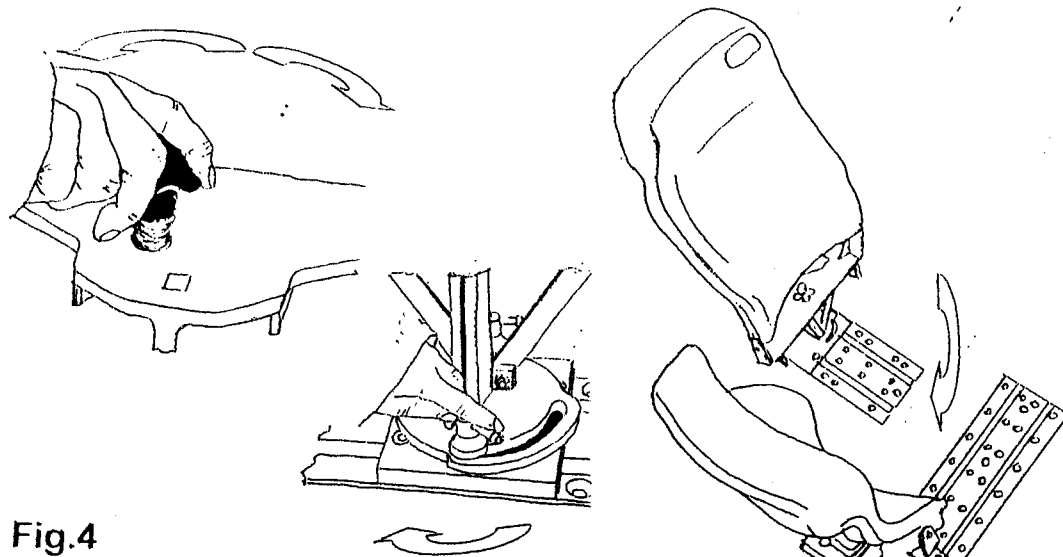

Fig.4

To position window seat flush against the wall.

First unscrew the black finger knob anti-clockwise until the seat is loose.

Undo the two conical shaped locks at base of seat by using tommy bar fitted anti-clockwise.

Next rotate seat clockwise to its fullest extent. The seat should now be parallel to the side of the vehicle.

Now move the seat unit it touches the vehicle wall. To lock the seat in position relock the conical locks at the base of the seat first, then relock the black finger knob. The seat should now be rigid.

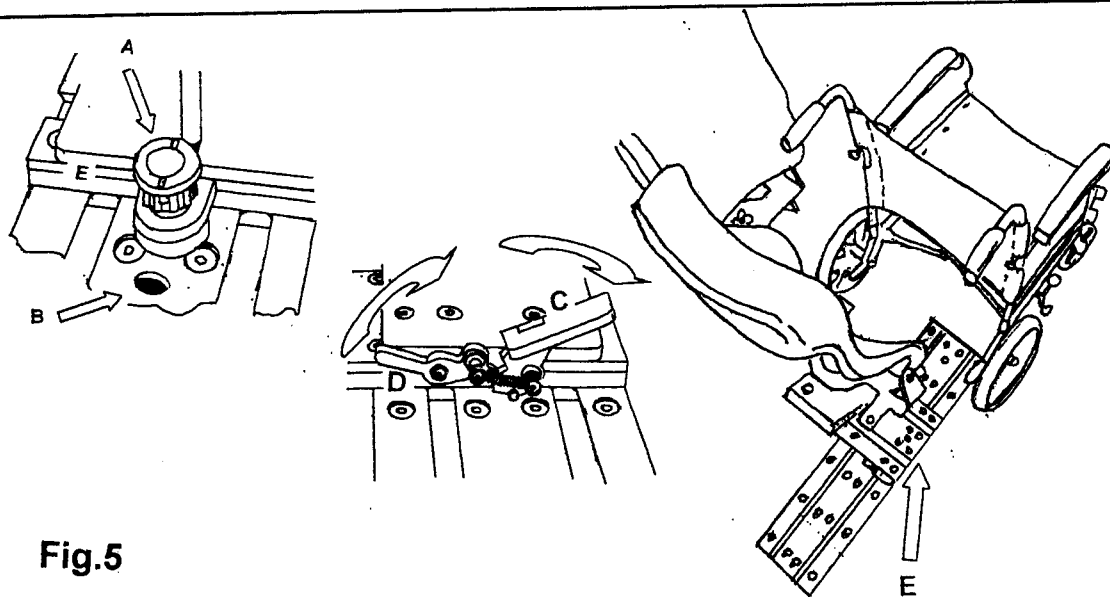

Fig.5

The seats are now configured to accept the wheelchair, once the wheelchair is positioned in the wheelchair space, the next step is to secure it.

First ensure that the two directional indicators on top of plunger cap 'A' are facing forward, this is to ensure the plunger will locate in hole 'B'. Plunger 'A' is located at the front of the seat base.

Next move the seat forward which is mounted on a secondary track plate 'E' until the plunger locates into plunger hole 'B' now lock the seat base plate in position by using the foot lock Fig 3. Press down on foot pedal 'C' until the lock 'D' engages under the bottom tooth of the lock. An audible click will be heard when the lock is fully engaged.

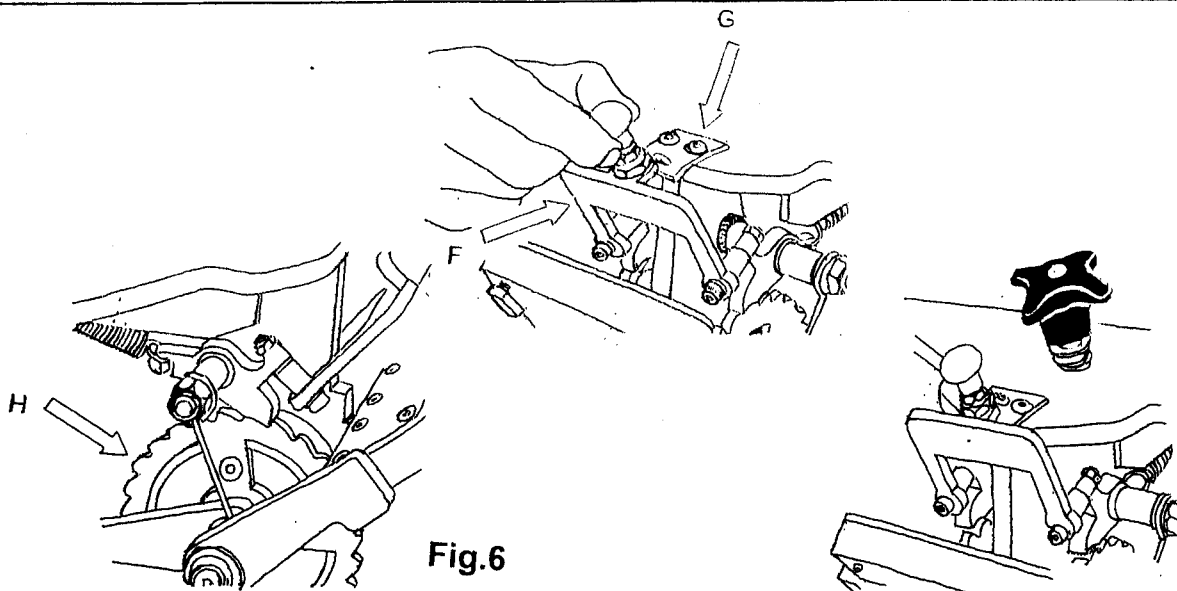

Fig.6

Once the Secondary track plate 'E' is locked in position with plunger 'A' engaged in hole B' the seat can be moved sideways toward the window side of the vehicle. Once the seat engages the stop the black finger knob can be re-locked turning in a clockwise direction until the seat is rigid.

CAUTION : Under no circumstances must the wheelchair be secured unless the seat is rigidly locked in position

The wheelchair can now be connected to the seat via the webbing belts with karabiners on the end. Firstly the webbing belts must be released from the webbing drums 'H' located on each side of the central leg of the seat.

To release the webbing belts first disengage the locking dogs which are engaged in the webbing drum teeth. This is done by lifting the locking dog arm 'F' via the yellow sprung loaded knob located at the rear of the seat. Directly above the locking dog arm is a catchment plate with a slot in it 'G'. Once the yellow sprung loaded plunger is in contact with the catchment plate release the yellow knob. The plunger will now locate in the slot and keep the locking dogs clear of the webbing drums.

The webbing is now free to be pulled out from the seat. Note : pull the webbing out to its fullest extent. Now position the wheelchair so that the webbing can be attached to the rear of the wheelchair frame via the karabiners. Note : the karabiners should be located as far down on the wheelchair frame as possible.

CAUTION : Under no circumstances must the karabiners be attached to the front of wheelchair frame.

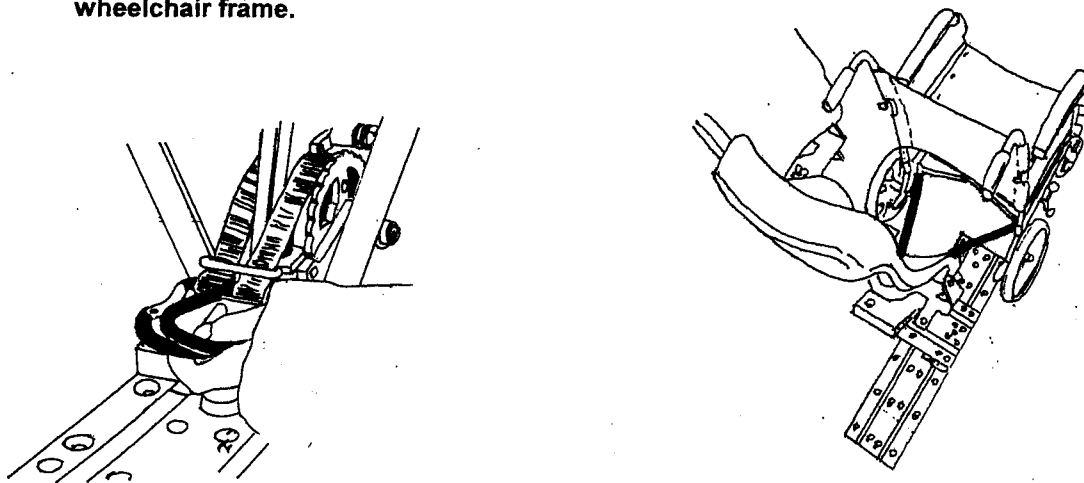

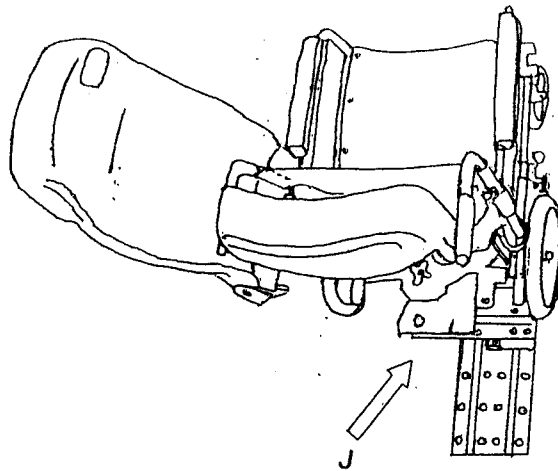

Fig.7

Once the webbing belts have been attached to the wheelchair it can now be ratcheted back until it is a snug fit against the seat back.

First re-engage the ratchet dogs by releasing locking dog arm 'F' from the catchment plate 'G' and allowing the locking dogs to re-mesh with the teeth on the webbing drum 'H'

To pull the wheelchair back operate the foot pedal 'J' in an up and down motion until the wheelchair is secure against the seat back.

Caution: Never travel with any forward or backward movement of the wheelchair. It must always be a tight snug fit to the seat back.

To re-configure the seats to the original position reverse the operating instructions.

Note: When releasing the wheelchair follow these procedures. Apply pressure to the foot pedal 'J' at the same time lift locking dog arm 'F' and re-engage with the catchment plate 'G' the wheelchair can now be pushed forward and the karabiners disengaged.

Once the karabiners are free the webbing belts can be ratcheted back onto the webbing drums by disengaging the locking dog arm 'F' and allowing it to mesh with the webbing drum teeth 'H'. Now operate the foot pedal 'J' until the webbing is fully retracted onto the drums.

Note: When ratcheting the webbing back onto the drums do not over tighten.